

These are the notes referred to on the following official copy

Title Number HW120830

The electronic official copy of the document follows this message.

This copy may not be the same size as the original.

Please note that this is the only official copy we will issue. We will not issue a paper official copy.

with an
ere to
fence
ndors
ndors
of and
part
that
ved to
operty
us or
right
rwise
oining
anted
er by
: 1925
oughs
of the
yance
Twenty
ghty-
ne one
livery
n the
hereby
ion or
ch the

Grown copyright. All rights reserved
OFFICE COPY
ISSUED BY THE GLOUCESTER
DISTRICT LAND REGISTRY

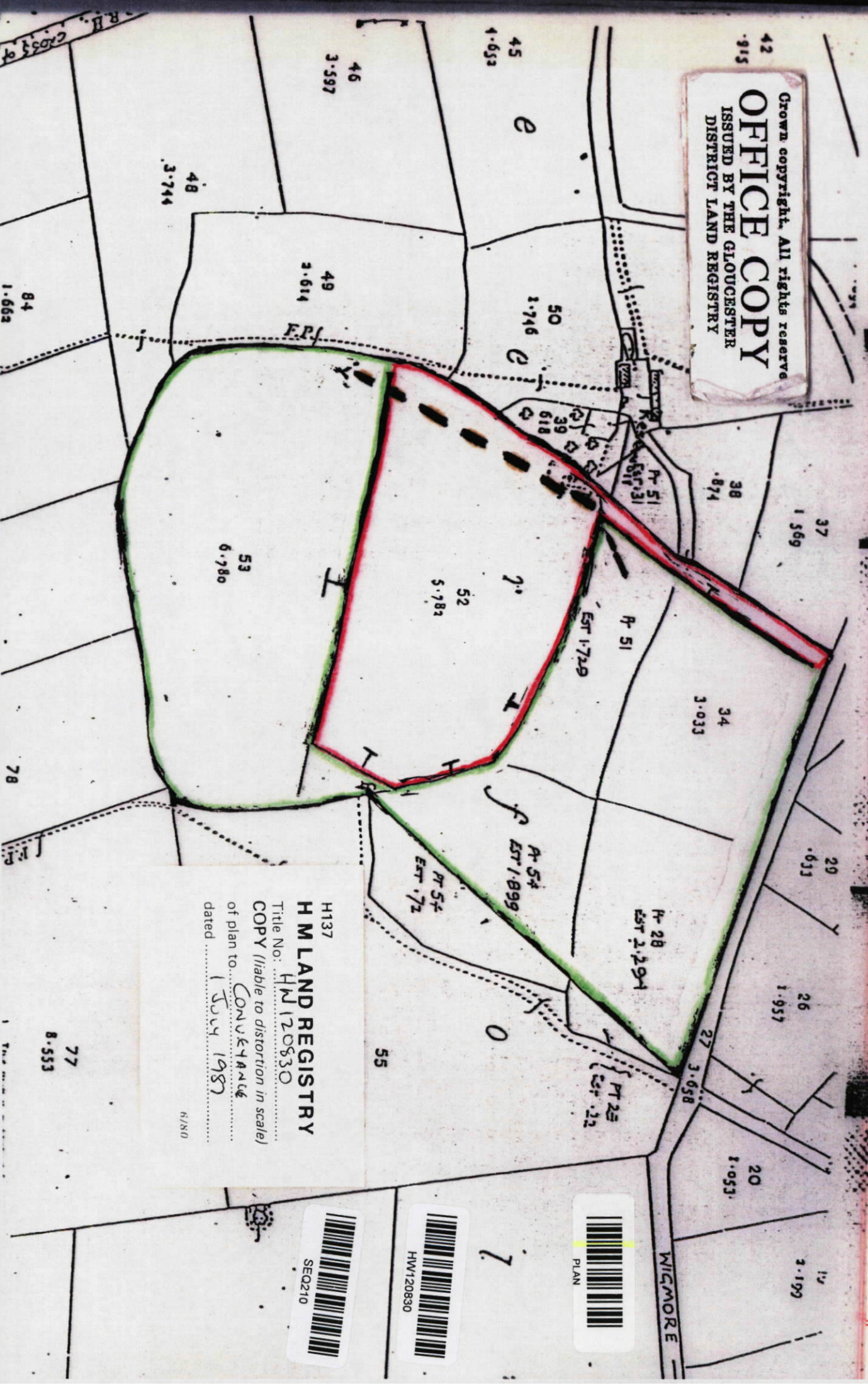

H137
H M LAND REGISTRY
Title No: **HM120830**
COPY (liable to distortion in scale)
of plan to: **CONVEYANCE**
dated: **1 JULY 1987**
6/80

