

These are the notes referred to on the following official copy

Title Number SL155843

The electronic official copy of the document follows this message.

This copy may not be the same size as the original.

Please note that this is the only official copy we will issue. We will not issue a paper official copy.

WATERLOW & SONS, LIMITED,
LONDON WALL,
LONDON.

This Conveyance

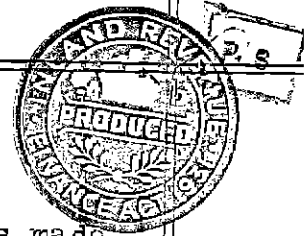

is made

the ~~Fourth~~ day of ~~May~~ One thousand Nine hundred and Sixty B E T W E E N FLORENCE EDITH JENNINGS of Number 1 Five Ways Ruyton of the Eleven Towns in the County of Salop Married Woman (hereinafter called "the Vendor") of the one part and MARGARET HERBERTA PHILLIPS of Number 17 Overton Richards Castle near Ludlow in the said County of Salop Spinster (hereinafter called "the Purchaser") of the other part.

W H E R E A S :-

THE VENDOR is seized in fee simple free from incumbrances of the property hereinafter described and has agreed with the Purchaser for the sale thereof to her at the price of Four Hundred and Fifty Pounds.

N O W THIS DEED WITNESSETH as follows :-

1. IN consideration of FOUR HUNDRED AND FIFTY POUNDS paid by the Purchaser to the Vendor (the receipt whereof the Vendor hereby acknowledges) the Vendor as Beneficial Owner hereby conveys Unto the Purchaser ALL THAT piece or parcel of land situate in the Parish of Richards Castle in the County of Salop containing One Rood Seven and a half Perches or thereabouts Together with the dwellinghouse and



photo
Copy

FF 75
13

buildings and erections on the said land or on some part or parts thereof and known as Number 17 Overton aforesaid All of which property is further described in the Schedule hereto and is delineated on the plan annexed hereto and is thereon edged red TO HOLD the same Unto the Purchaser in fee simple subject as to that part of the property coloured brown on the said plan to a right of way on foot only for the owners and occupiers of the adjoining property Number 16 Overton aforesaid.

2. IT is hereby certified that the transaction hereby effected does not form part of a larger transaction or of a series of transactions in respect of which the amount or value or the aggregate amount or value of the consideration exceeds Three Thousand Five Hundred Pounds.

I N W I T N E S S whereof the parties hereto have hereunto set their hands and seals the day and year first above written.

THE SCHEDULE above referred to.

<u>No. on O.S. Map.</u>	<u>Description.</u>	<u>Area.</u>
Part 73	Garden	.197
Part 74	Cottage and Outbuildings	:100
	Total	<u>.297 Acres</u>

SIGNED SEALED AND DELIVERED
by the said FLORENCE EDITH
JENNINGS in the presence
of :-

} 78 Jennings

R. N. Peck
Witness
Orestis



APPROVED AND SIGNED
BY THE ENGINEER
IN CHARGE

Handwritten notes in blue ink, possibly including a name and date.

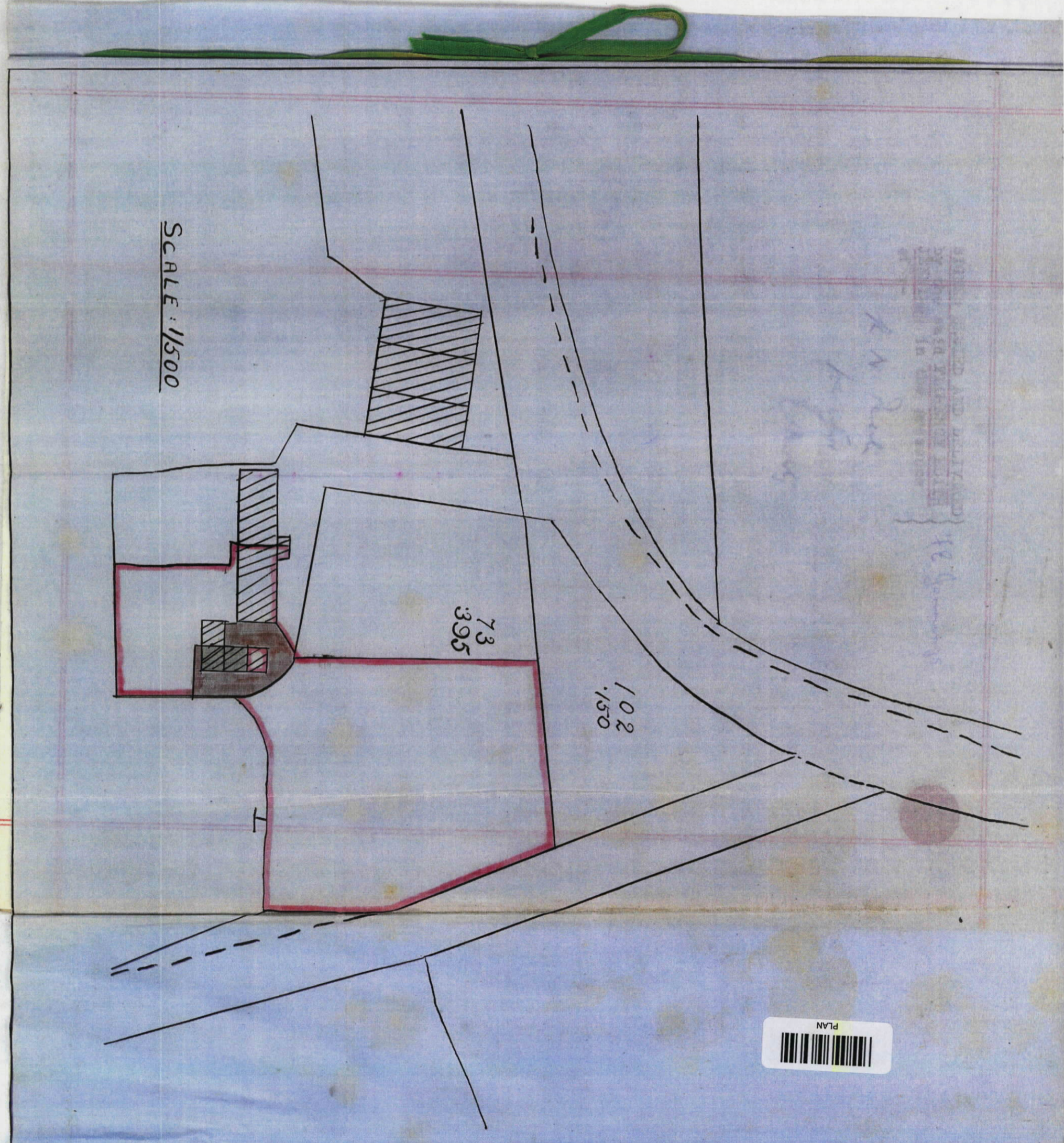

SCALE: 1/500

PLAN
[Barcode]