

**These are the notes referred to on the following official copy**

Title Number SL158702

The electronic official copy of the document follows this message.

This copy may not be the same size as the original.

Please note that this is the only official copy we will issue. We will not issue a paper official copy.

CARBBS  
Solicitors

of part  
registered title(s)

Use more room than is provided for in a panel, use continuation sheet CS and staple to this form)

Stamp Duty

Place "X" in the box that applies and complete the box in the appropriate certificate.

It is certified that this instrument falls within category  in the Schedule to the Stamp Duty (Exempt Instruments) Regulations 1987

It is certified that the transaction effected does not form part of a larger transaction or of a series of transactions in respect of which the amount or value or the aggregate amount or value of the consideration exceeds the sum of

£ 60,000.00

I/We hereby certify that this instrument is exempt from stamp duty by virtue of the provisions of Section 92 of the Finance Act 2001

2. Title number(s) out of which the Property is transferred (leave blank if not yet registered)

SL 155 843

3. Other title number(s) against which matters contained in this transfer are to be registered (if any)

4. Property transferred (Insert address, including postcode, or other description of the property transferred. Any physical exclusions, e.g. mines and minerals, should be defined. Any attached plan must be signed by the transferor and by or on behalf of the transferee)  
Land at 17 Overton, Near Ludlow, Shropshire SY8 4DY

The Property is defined: (Place "X" in the box that applies and complete the statement)

on the attached plan and shown edged red (state reference e.g. "edged red")

on the Transferor's filed plan and shown (state reference e.g. "edged and numbered 1 in blue")

Photo  
Copy

5. Date 28<sup>th</sup> January 2004

6. Transferor (give full names and Company's Registered Number if any)

David Erwin Harris and Margaret Ellen Harris



SL158702

7. Transferee for entry on the register (Give full names and Company's Registered Number if any; for Scottish Co. Reg. Nos., use an SC prefix. For foreign companies give territory in which incorporated.)

Maurice Bellwood and Gwenneth Bellwood



SEQ196

Unless otherwise arranged with Land Registry headquarters, a certified copy of the transferee's constitution (in English or Welsh) will be required if it is a body corporate but is not a company registered in England and Wales or Scotland under the Companies Acts.

8. Transferee's intended address(es) for service in the U.K. (including postcode) for entry on the register

Twigs Way, Overton, Ludlow SY8 4SX

9. The Transferor transfers the Property to the Transferee.

is a deed by  
WOOD and  
ELLEN HARRIS  
in the presence of

10. Consideration (Place "X" in the box that applies. State clearly the currency unit if other than sterling. If none of the boxes applies, insert an appropriate memorandum in the additional provisions panel.)

- The Transferor has received from the Transferee for the Property the sum of (in words and figures) £3,500.00 (three thousand five hundred pounds)
- (insert other receipt as appropriate)
- The transfer is not for money or anything which has a monetary value

11. The Transferor transfers with (Place "X" in the box which applies and add any modifications)

- full title guarantee       limited title guarantee

12. Declaration of trust Where there is more than one transferee, place "X" in the appropriate box.

- The Transferees are to hold the Property on trust for themselves as joint tenants.
- The Transferees are to hold the Property on trust for themselves as tenants in common in equal shares.
- The Transferees are to hold the Property (complete as necessary)

13. Additional Provisions

1. Use this panel for:

- definitions of terms not defined above
- rights granted or reserved
- restrictive covenants
- other covenants
- agreements and declarations
- other agreed provisions
- required or permitted statements, certificates or applications.

2. The prescribed subheadings printed in the form as set out in Schedule 1 to the Land Registration Rules 1925 may be inserted, added to, amended, repositioned or omitted.

**Covenant by Transferee**

The Transferee hereby covenants with the Transferor to erect within a period of three months a wooden panel fence or brick wall of not more than two metres in height along the boundary marked C-D on the plan attached.

14. The Transferors and all other necessary parties (including the proprietors of all the titles listed in panel 3) should execute this transfer as a deed using the space below and sign the plan. Forms of execution are given in Schedule 3 to the Land Registration Rules 1925. If the transfer contains transferees' covenants or declarations or contains an application by them (e.g. for a restriction), it must also be executed by the Transferees.

Signed as a deed by the said DAVID ERWIN HARRIS and MARAGRET ELLEN HARRIS in the presence of:

Sign here  
*David Harris*  
*Maragret Harris*

*[Signature]*  
Signature of witness

Name (in BLOCK CAPITALS) JANE ERWIN HARRIS  
Address 1 Alton Court Manor, Leamington, HR6 8 BS  
Occupation Solicitor

1.00 (three thou)

axes

is a deed by the said MAURICE WOOD and ~~ET AL~~ in the presence of GWINNETH BELLWOOD in the presence of:

Sign here  
X Maurice Bellwood  
X C. Bellwood

Signature of witness *Morgan*  
Name (in BLOCK CAPITALS) Morgan  
Address 7 Mill St Ludlow Shropshire  
Occupation Receptionist

Panel 13 continued

**Reservation for Benefit of the Transferor**

There is reserved to the Transferor the right to use any existing drains and pipes passing through or under the property for the passage of soil and water.

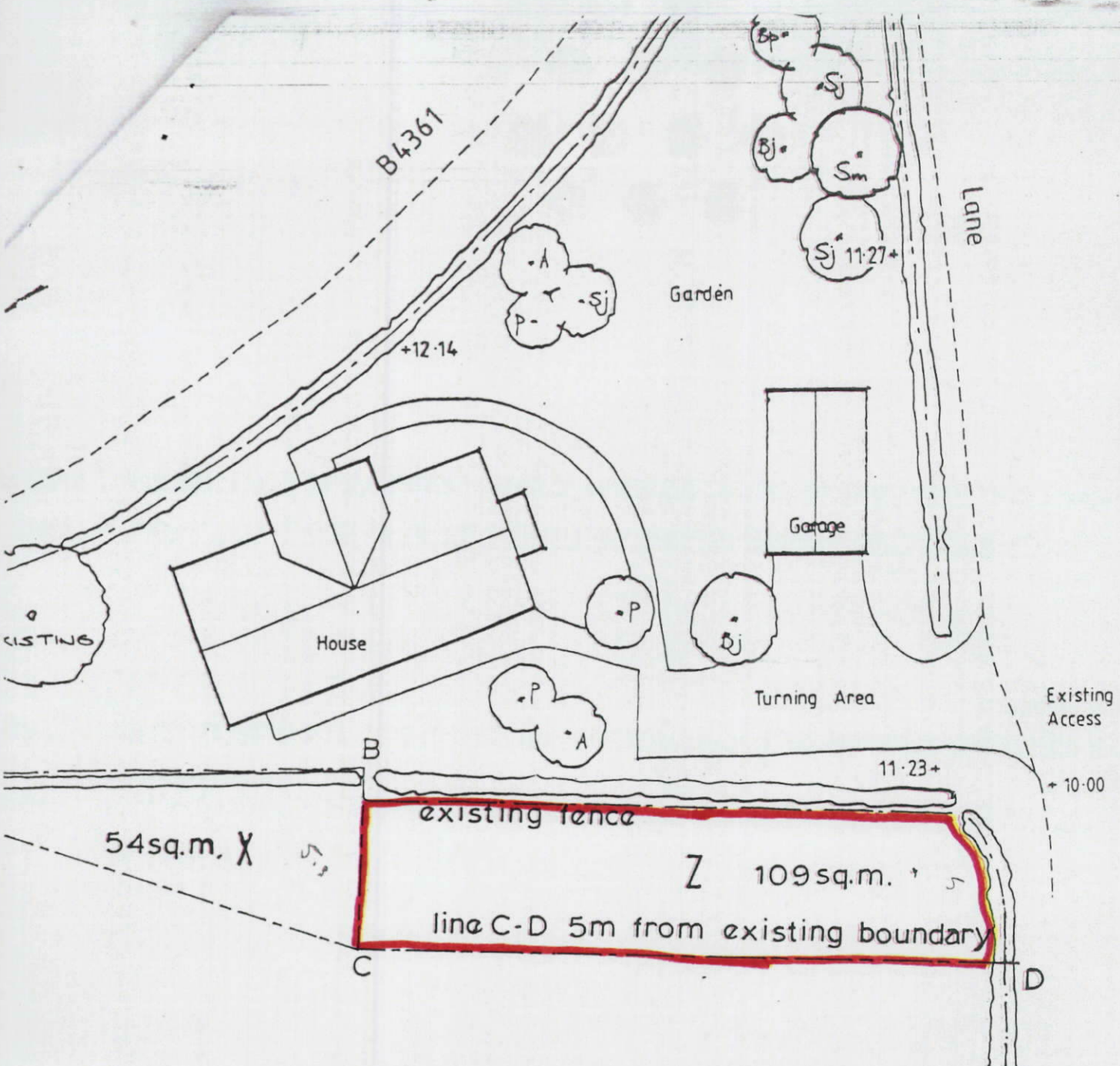

*W. Davis*  
*W. G. Davis*

TON, LUDLOW : scale 1:200.

